

**REVISIONS**

<b>REV #</b>	<b>Description of Change</b>	<b>Engineer</b>	<b>Date</b>
A	New Document	GAA	10/14/19
B	Updated CFG Numbers	JJK	10/14/19
C	Fixed some Bezel/Trim Plate PNs	DOE	10/18/19
D	Switched USB module 107665-0125 for 107665-0145 on -T1602	JJK	12/10/19
E	CSS-ALTO-D2201	JJK	01/07/20
F	Updated TP for -0001 through -0009	JJK	01/30/20
G	Added CSS-ALTO-D1303	JJK	02/06/20

**Description**

CSS Switch Configurations for ALTO Pre-Configuration

1.0 Aircraft Info

<b>Aircraft Manufacturer</b>	ALTO	
<b>Aircraft Model</b>		
<b>Aircraft SN</b>		
<b>Customer</b>		
<b>Plating PN / Description</b> (color, sheen, etc. – any info needed by Vendor)	No Plating	
<b>Does Plating have a Direction (graining)</b>	No Plating	<b>If YES, each CFG variation will need a grain direction defined</b>
<b>Plating Vendor</b>	No Plating	
<b>Configuration PN Format</b>	CSS-XY-ZZZZ	<b>X = Aircraft Type (example: GV, GIV, F900, F7X, CL604, etc)</b>
		<b>Y = Aircraft Serial Number (maximum # digits for XY is 8)</b>
		<b>ZZ = Variant (sequential from 01)</b>

2.0 Switch Configurations

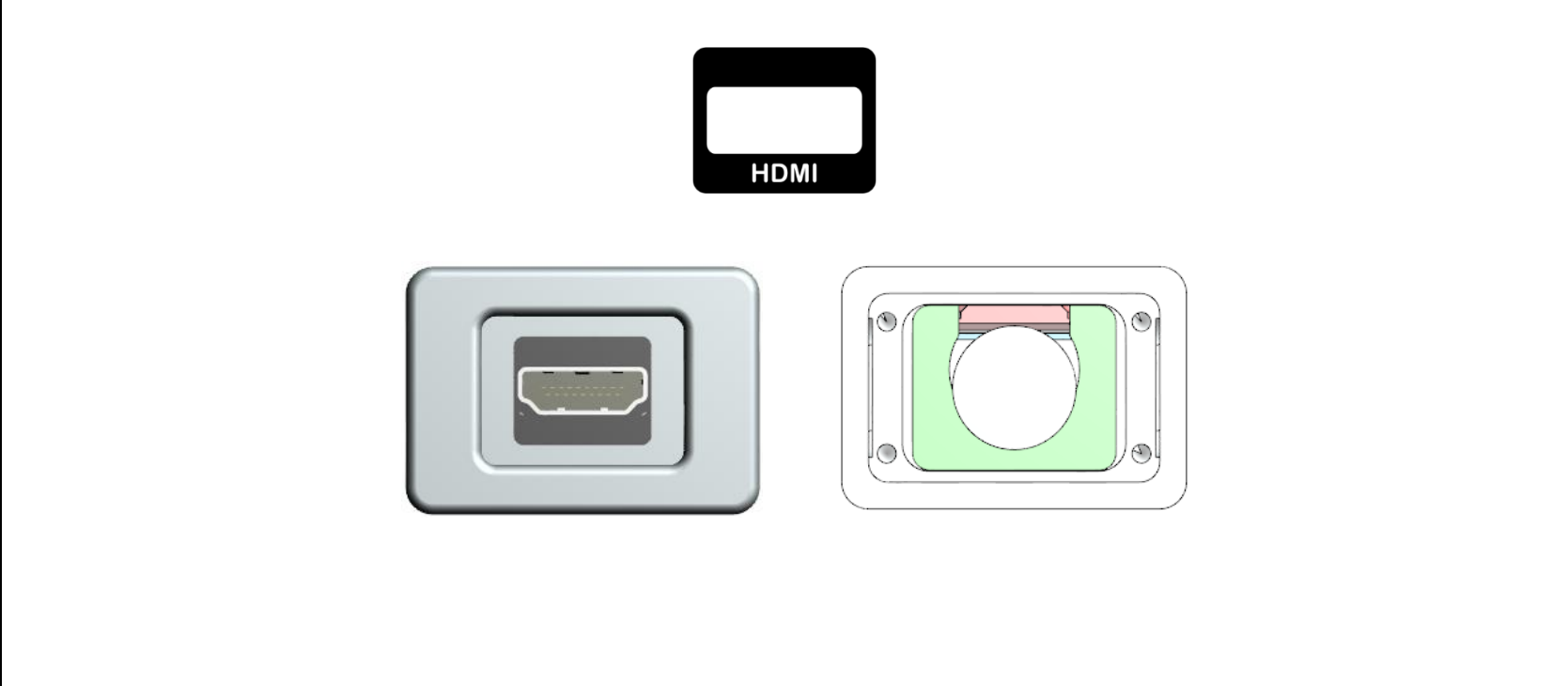

<b>Configuration #</b>	CSS-ALTO-D1101	<b>Plating Grain Direction</b>	
<b>Quantity</b>	1		
<b>BOM Rev #</b>	2		

Items in Configuration		
Description	PN	Quantity
Bezel	202582-D1101-R1	1
Trim Plate	201591-M11H03-R1	1
HDMI to DVI Module	107665-0155-00010	1
Overlay – HDMI – text	201466-0254	1

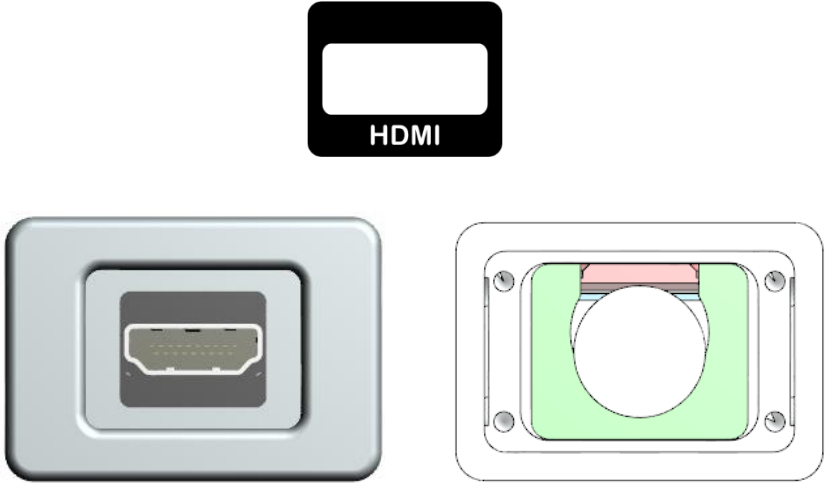

<b>Configuration #</b>	CSS-ALTO-D1102	<b>Plating Grain Direction</b>	↔
<b>Quantity</b>	1		
<b>BOM Rev #</b>	2		
Items in Configuration			
Description	PN	Quantity	
Bezel	202582-D1101-R1	1	
Trim Plate	201591-M11H03-R1	1	
HDMI Extension Module	107665-0165-00010	1	
Overlay – HDMI – text	201466-0254	1	

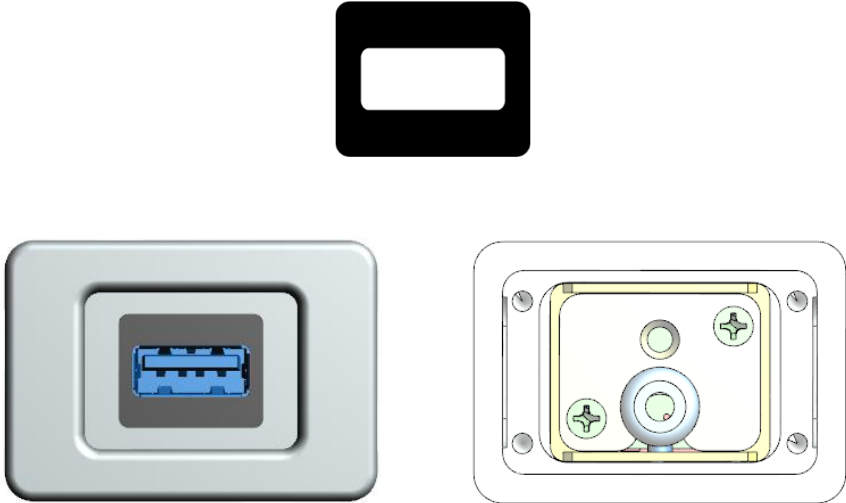

<b>Configuration #</b>	CSS-ALTO-D1103	<b>Plating Grain Direction</b>	
<b>Quantity</b>	1		
<b>BOM Rev #</b>	2		

Items in Configuration		
Description	PN	Quantity
Bezel	202582-D1101-R1	1
Trim Plate	201591-M11H03-R1	1
USB Data Port 1x1	107665-0105-00010	1
Overlay – USB	201466-0029	1

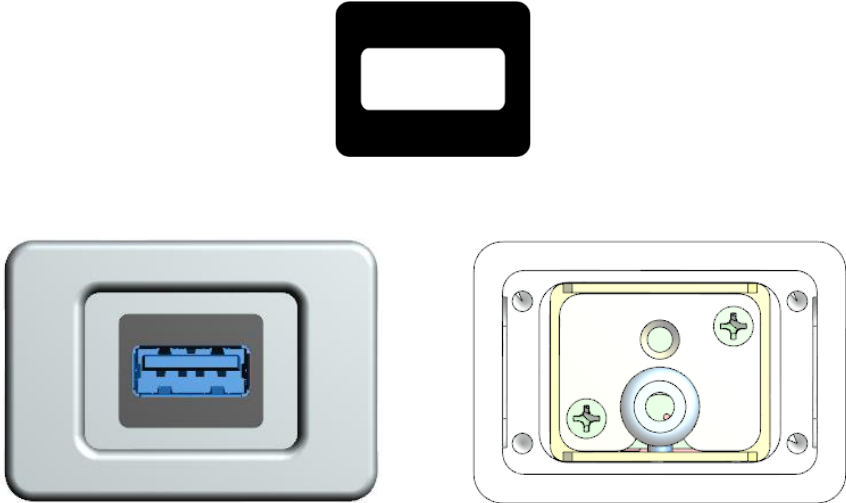

<b>Configuration #</b>	CSS-ALTO-D1104	<b>Plating Grain Direction</b>	
<b>Quantity</b>	1		
<b>BOM Rev #</b>	2		

Items in Configuration		
Description	PN	Quantity
Bezel	202582-D1101-R1	1
Trim Plate	201591-M11H03-R1	1
USB Power Module 1x1	107665-0115-00010	1
Overlay – USB	201466-0029	1

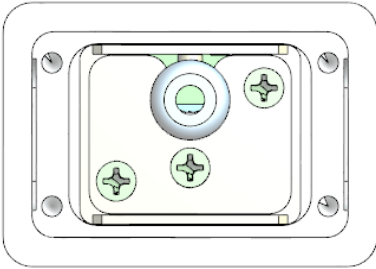

<b>Configuration #</b>	CSS-ALTO-D1105	<b>Plating Grain Direction</b>	
<b>Quantity</b>	1		
<b>BOM Rev #</b>	2		

Items in Configuration		
Description	PN	Quantity
Bezel	202582-D1101-R1	1
Trim Plate	201591-M11H03-R1	1
1 position switch w/ indicator	107660-0001-00010	1
Overlay – VIDEO SELECT	201466-0020	1

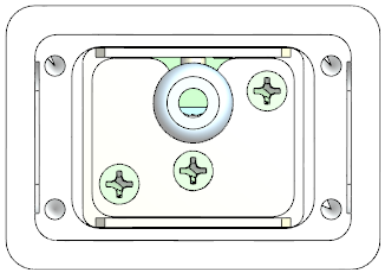

<b>Configuration #</b>	CSS-ALTO-D1106	<b>Plating Grain Direction</b>	
<b>Quantity</b>	1		
<b>BOM Rev #</b>	2		

Items in Configuration		
Description	PN	Quantity
Bezel	202582-D1101-R1	1
Trim Plate	201591-M11H03-R1	1
1 position switch w/ indicator	107660-0001-00010	1
Overlay – HD SELECT	201466-0321	1



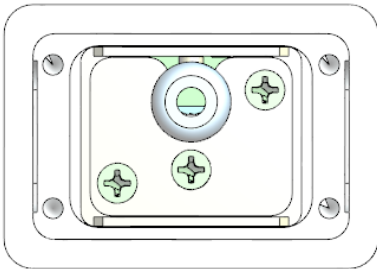

<b>Configuration #</b>	CSS-ALTO-D1107	<b>Plating Grain Direction</b>	
<b>Quantity</b>	1		
<b>BOM Rev #</b>	2		

Items in Configuration		
Description	PN	Quantity
Bezel	202582-D1101-R1	1
Trim Plate	201591-M11H03-R1	1
1 position switch w/ indicator	107660-0001-00010	1
Overlay – BLUETOOTH ENABLE	201466-0271	1

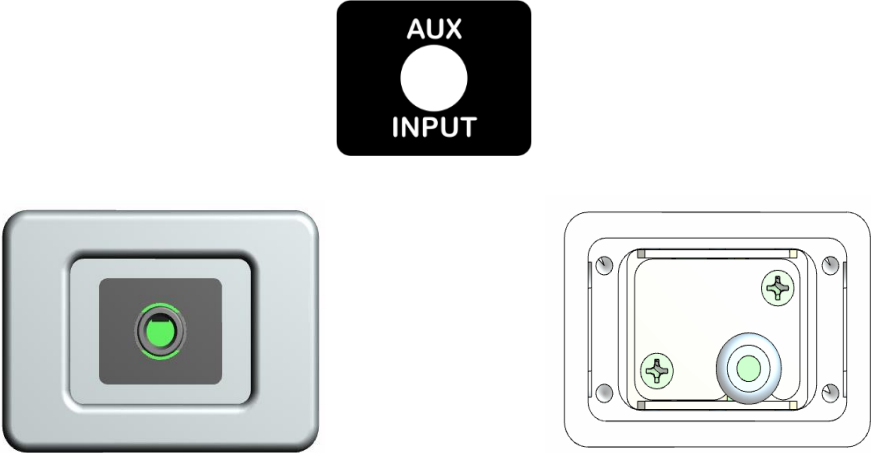

<b>Configuration #</b>	CSS-ALTO-D1108	<b>Plating Grain Direction</b>	
<b>Quantity</b>	1		
<b>BOM Rev #</b>	2		
Items in Configuration			
Description	PN	Quantity	
Bezel	202582-D1101-R1	1	
Trim Plate	201591-M11H03-R1	1	
1/8" Jack Module	107665-0100-00010	1	
Overlay – AUX INPUT	201466-0007	1	

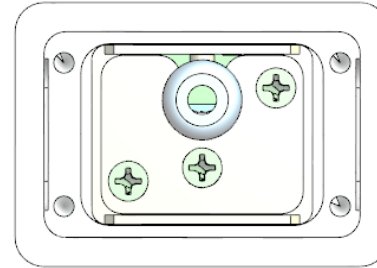

<b>Configuration #</b>	CSS-ALTO-D1109	<b>Plating Grain Direction</b>	
<b>Quantity</b>	1		
<b>BOM Rev #</b>	2		

Items in Configuration		
Description	PN	Quantity
Bezel	202582-D1101-R1	1
Trim Plate	201591-M11H03-R1	1
1 position switch w/ indicator	107660-0001-00010	1
Overlay – TOILET FLUSH ICON	201466-0280	1

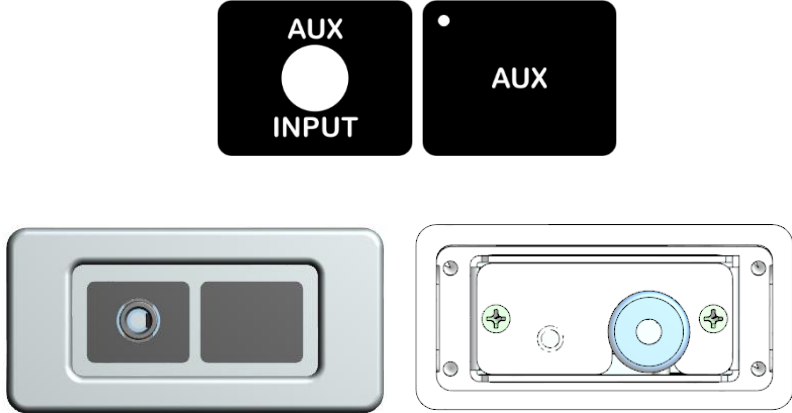

<b>Configuration #</b>	CSS-ALTO-D1201	<b>Plating Grain Direction</b>	
<b>Quantity</b>	1		
<b>BOM Rev #</b>	1		
Items in Configuration			
Description	PN	Quantity	
Bezel	202582-D1201-R1	1	
Trim Plate	201591-M12H01	1	
1 position w/ 1/8" jack	107660-0101-00010	1	
Overlay – AUX	201466-0288	1	
Overlay – AUX INPUT	201466-0007	1	

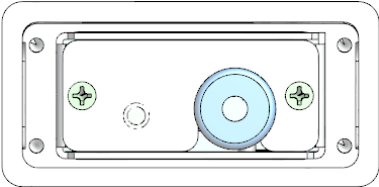
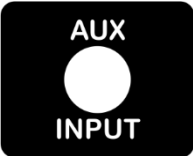

<b>Configuration #</b>	CSS-ALTO-D1202	<b>Plating Grain Direction</b>	
<b>Quantity</b>	1		
<b>BOM Rev #</b>	1		
Items in Configuration			
Description	PN	Quantity	
Bezel	202582-D1201-R1	1	
Trim Plate	201591-M12H01	1	
1 position w/ 1/8" jack	107660-0101-00010	1	
Overlay – BLUETOOTH ENABLE	201466-0271	1	
Overlay – AUX INPUT	201466-0007	1	

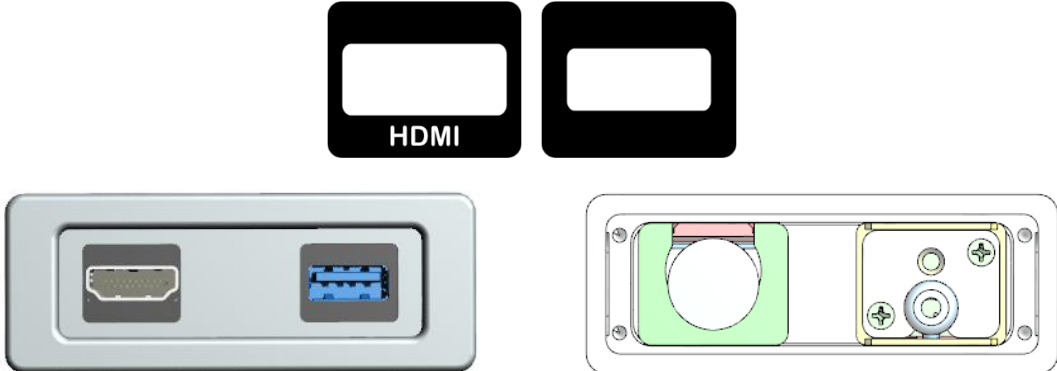

<b>Configuration #</b>	CSS-ALTO-D1301	<b>Plating Grain Direction</b>	↔
<b>Quantity</b>	1		
<b>BOM Rev #</b>	1		
Items in Configuration			
Description	PN	Quantity	
Bezel	202582-D1301-R1	1	
Trim Plate	201591-M13H03	1	
USB Power Module 1x1	107665-0115-00010	1	
HDMI Extension Module	107665-0165-00010	1	
Overlay – USB	201466-0029	1	
Overlay – HDMI – text	201466-0254	1	

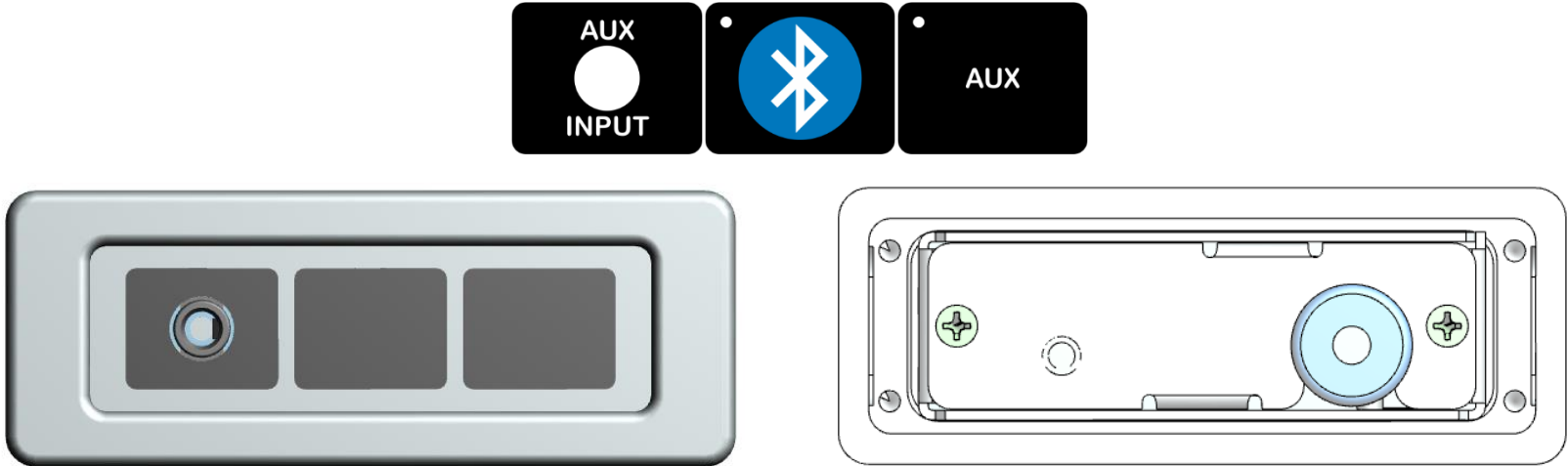

<b>Configuration #</b>	CSS-ALTO-D1302	<b>Plating Grain Direction</b>	↔
<b>Quantity</b>	1		
<b>BOM Rev #</b>	1		
Items in Configuration			
Description	PN	Quantity	
Bezel	202582-D1301-R1	1	
Trim Plate	201591-M13H01	1	
2 position w/ 1/8" jack	107660-0102-00010	1	
Overlay – AUX INPUT	201466-0007	1	
Overlay – BLUETOOTH ENABLE	201466-0271	1	
Overlay – AUX	201466-0288	1	

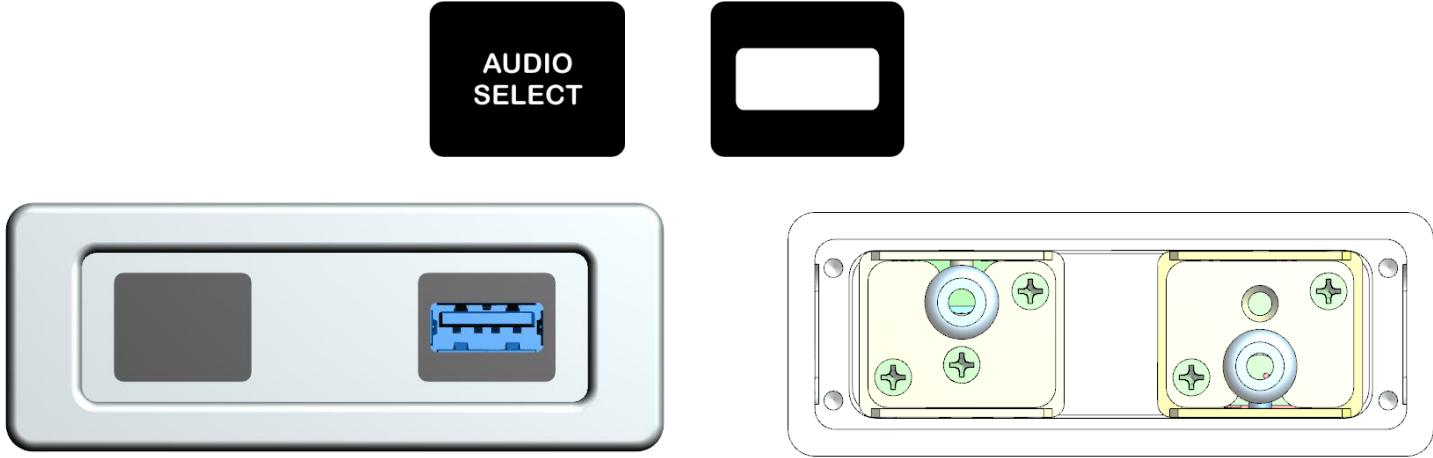

<b>Configuration #</b>	CSS-ALTO-D1303	<b>Plating Grain Direction</b>	↔
<b>Quantity</b>	1		
<b>BOM Rev #</b>	1		
Items in Configuration			
Description	PN	Quantity	
Bezel	202582-D1301-R1	1	
Trim Plate	201591-M13H03	1	
USB Power Module 1x1	107665-0115-00010	1	
1 position switch w/ indicator	107660-0001-00010	1	
Overlay – USB	201466-0029	1	
Overlay – AUDIO SELECT	201466-0003	1	



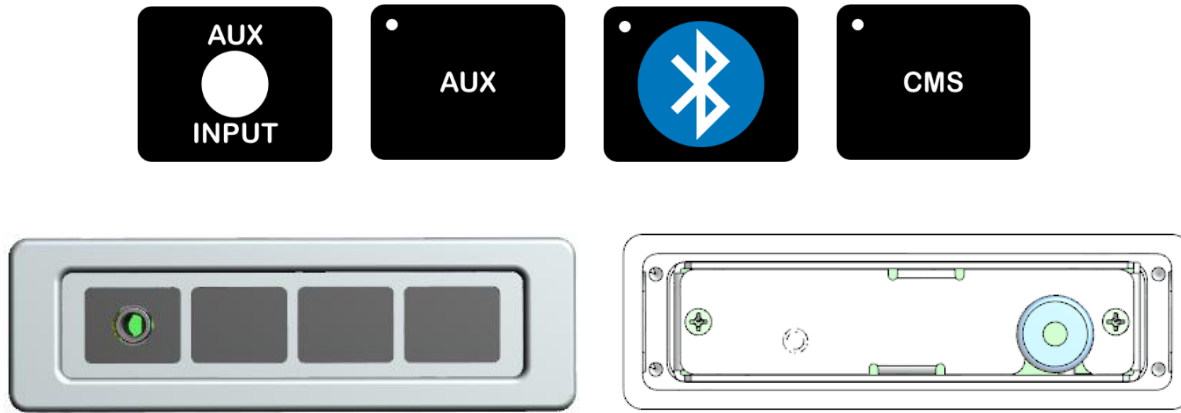

<b>Configuration #</b>	CSS-ALTO-D1401	<b>Plating Grain Direction</b>	↔
<b>Quantity</b>	1		
<b>BOM Rev #</b>	1		

Items in Configuration			
Description	PN	Quantity	
Bezel	202582-D1401-R1	1	
Trim Plate	201591-M14H01	1	
3 position w/ 1/8" jack	107660-0103-00010	1	
Overlay – CMS	201466-0289	1	
Overlay – BLUETOOTH ENABLE	201466-0271	1	
Overlay – AUX	201466-0288	1	
Overlay – AUX INPUT	201466-0007	1	

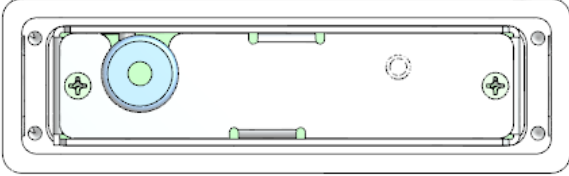

<b>Configuration #</b>	CSS-ALTO-D1402	<b>Plating Grain Direction</b>	
<b>Quantity</b>	1		
<b>BOM Rev #</b>	1		

Items in Configuration		
Description	PN	Quantity
Bezel	202582-D1401-R1	1
Trim Plate	201591-M14H01	1
4 position switch w/ indicator	107660-0004-00010	1
Overlay – SPKR ON OFF	201466-0278	1
Overlay – VOLUME UP	201466-0001	1
Overlay – VOLUME DOWN	201466-0002	1
Overlay – BLUETOOTH ENABLE	201466-0271	1

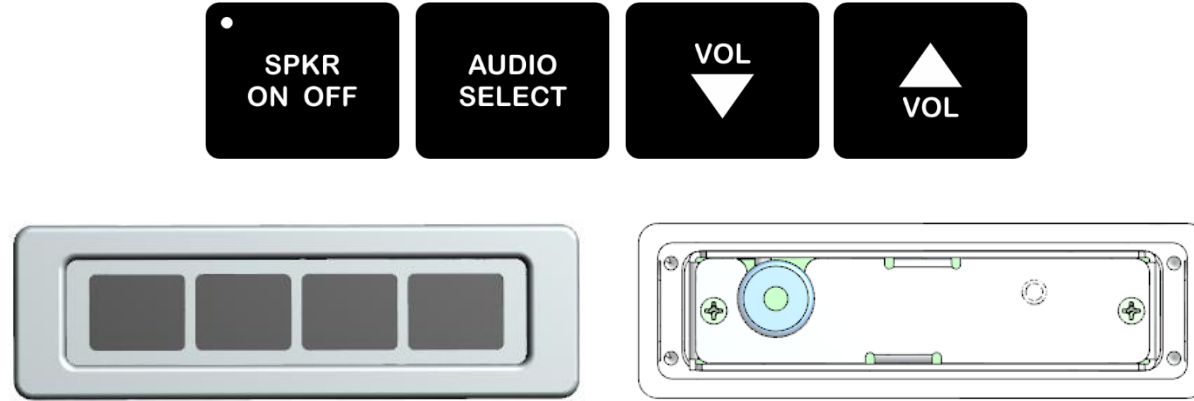

<b>Configuration #</b>	CSS-ALTO-D1403	<b>Plating Grain Direction</b>	<b>↔</b>
<b>Quantity</b>	1		
<b>BOM Rev #</b>	1		

Items in Configuration		
Description	PN	Quantity
Bezel	202582-D1401-R1	1
Trim Plate	201591-M14H01	1
4 position switch w/ indicator	107660-0004-00010	1
Overlay – VOLUME UP	201466-0001	1
Overlay – VOLUME DOWN	201466-0002	1
Overlay – AUDIO SELECT	201466-0003	1
Overlay – SPKR ON OFF	201466-0278	1

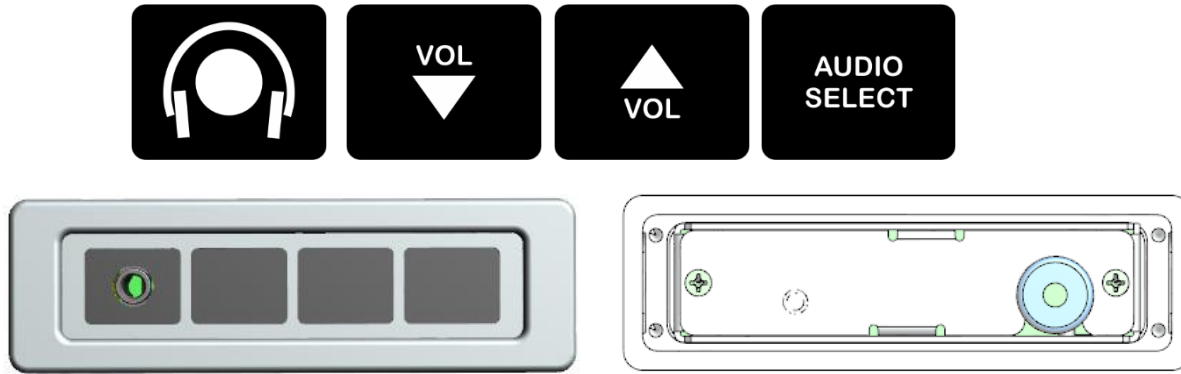

<b>Configuration #</b>	CSS-ALTO-D1404	<b>Plating Grain Direction</b>	↔
<b>Quantity</b>	1		
<b>BOM Rev #</b>	1		
Items in Configuration			
Description	PN	Quantity	
Bezel	202582-D1401-R1	1	
Trim Plate	201591-M14H01	1	
3 position w/ 1/8" jack	107660-0103-00010	1	
Overlay – VOLUME UP	201466-0001	1	
Overlay – VOLUME DOWN	201466-0002	1	
Overlay – AUDIO SELECT	201466-0003	1	
Overlay – HEADPHONE JACK	201466-0022	1	

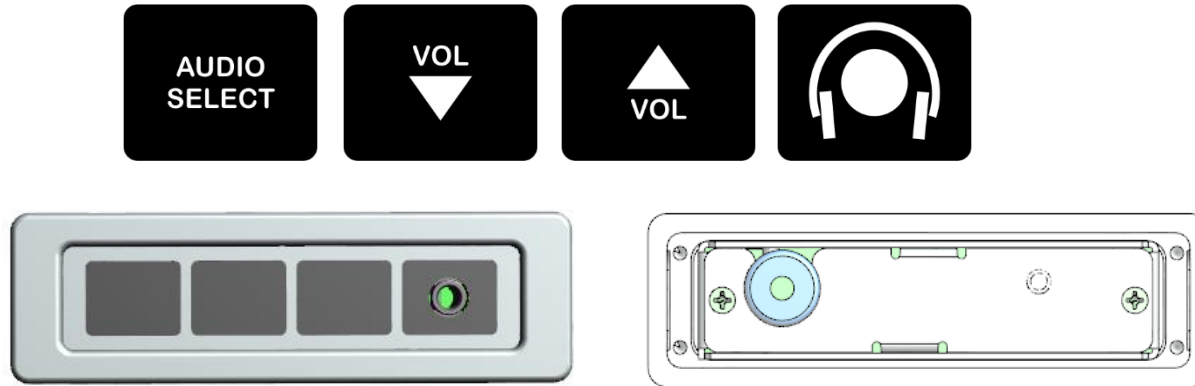

<b>Configuration #</b>	CSS-ALTO-D1405	<b>Plating Grain Direction</b>	<b>↔</b>
<b>Quantity</b>	1		
<b>BOM Rev #</b>	1		
Items in Configuration			
Description	PN	Quantity	
Bezel	202582-D1401-R1	1	
Trim Plate	201591-M14H01	1	
3 position w/ 1/8" jack	107660-0103-00010	1	
Overlay – HEADPHONE JACK	201466-0022	1	
Overlay – VOLUME UP	201466-0001	1	
Overlay – VOLUME DOWN	201466-0002	1	
Overlay – AUDIO SELECT	201466-0003	1	

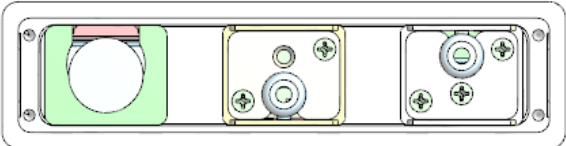

<b>Configuration #</b>	CSS-ALTO-D1501	<b>Plating Grain Direction</b>	<b>↔</b>
<b>Quantity</b>	1		
<b>BOM Rev #</b>	1		
Items in Configuration			
Description	PN	Quantity	
Bezel	202582-D1501-R1	1	
Trim Plate	201591-M15H04	1	
HDMI Extension Module	107665-0165-00010	1	
1/8" jack only	107665-0100-00010	1	
USB Power Module 1x1	107665-0115-00010	1	
Overlay – AUX INPUT	201466-0007	1	
Overlay – USB	201466-0029	1	
Overlay – HDMI- TEXT	201466-0254	1	

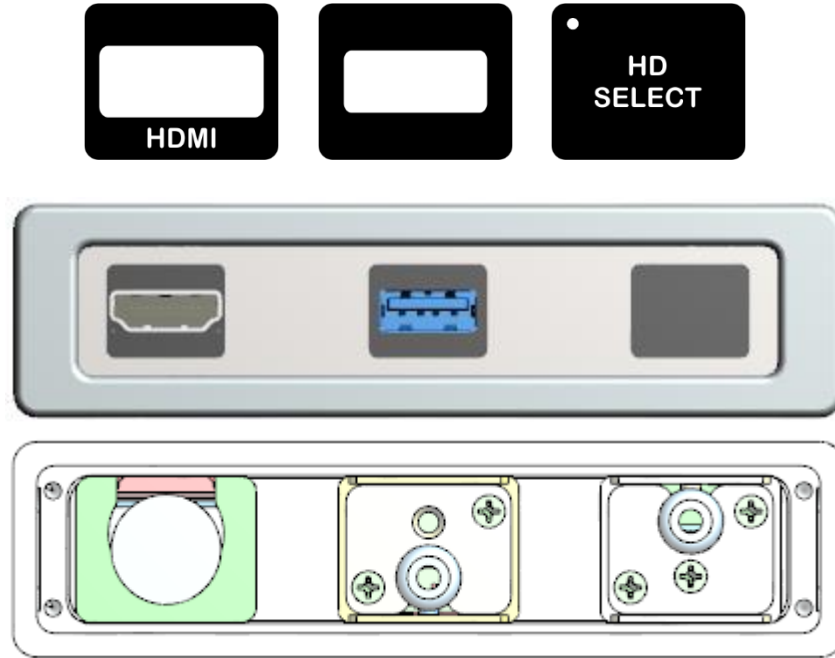

<b>Configuration #</b>	CSS-ALTO-D1502	<b>Plating Grain Direction</b>	<b>↔</b>
<b>Quantity</b>	1		
<b>BOM Rev #</b>	1		
Items in Configuration			
Description	PN	Quantity	
Bezel	202582-D1501-R1	1	
Trim Plate	201591-M15H04	1	
HDMI Extension Module	107665-0165-00010	1	
1 position switch w/ indicator	107660-0001-00010	1	
USB Power Module 1x1	107665-0115-00010	1	
Overlay – HD SELECT	201466-0321	1	
Overlay – USB	201466-0029	1	
Overlay – HDMI- TEXT	201466-0254	1	

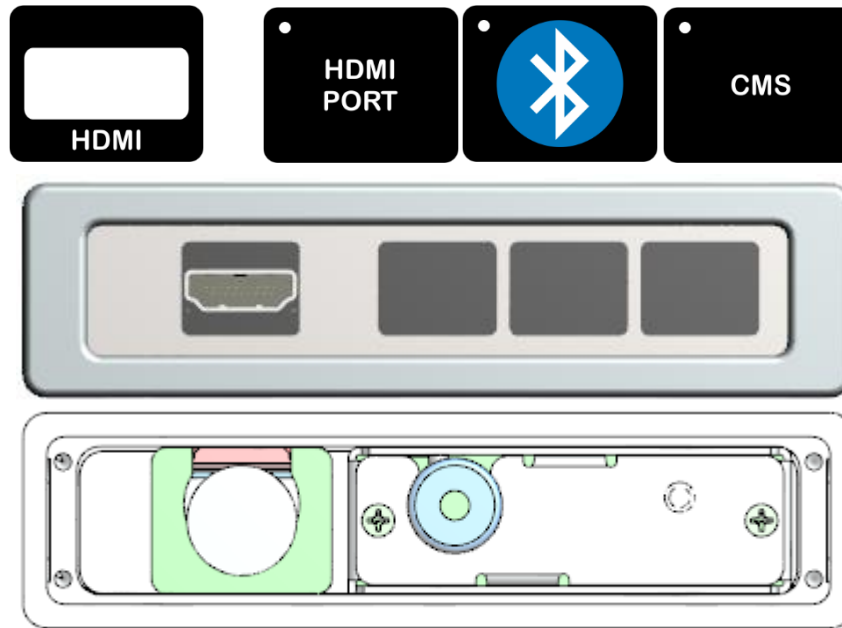

<b>Configuration #</b>	CSS-ALTO-D1503	<b>Plating Grain Direction</b>	
<b>Quantity</b>	1		
<b>BOM Rev #</b>	1		
Items in Configuration			
Description	PN	Quantity	
Bezel	202582-D1501-R1	1	
Trim Plate	201591-M15H02	1	
3 position switch w/ indicator	107660-0003-00010	1	
HDMI Extension Module	107665-0165-00010	1	
Overlay – CMS	201466-0289	1	
Overlay – BLUETOOTH ENABLE	201466-0271	1	
Overlay – HDMI PORT	201466-0388	1	
Overlay – HDMI- TEXT	201466-0254	1	



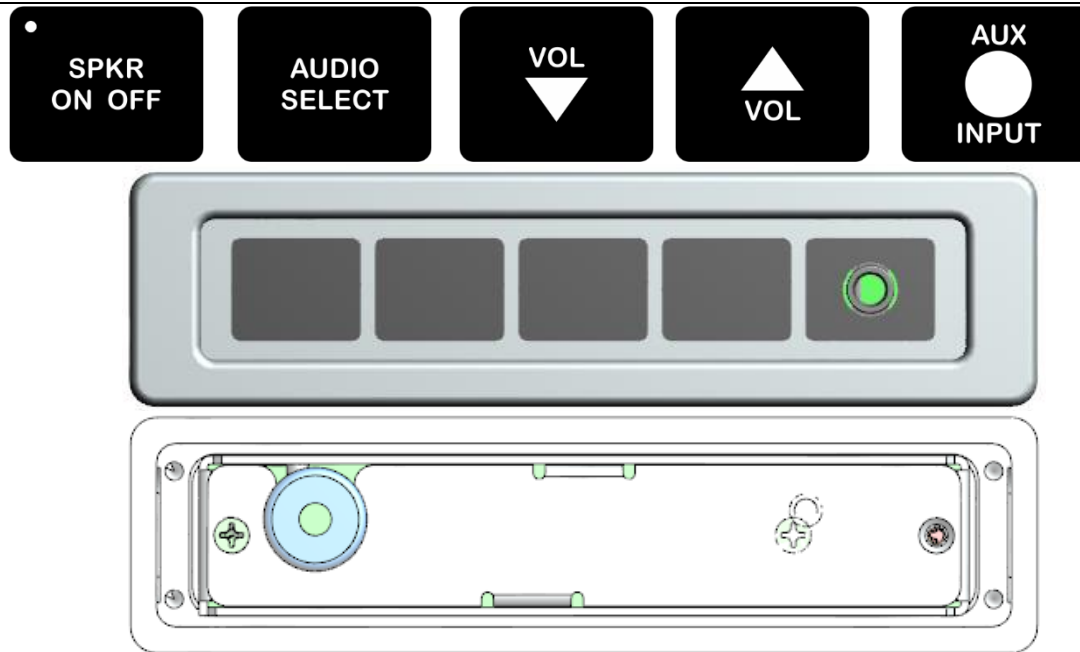

<b>Configuration #</b>	CSS-ALTO-D1504	<b>Plating Grain Direction</b>	<b>↔</b>
<b>Quantity</b>	1		
<b>BOM Rev #</b>	1		

Items in Configuration		
Description	PN	Quantity
Bezel	202582-D1501-R1	1
Trim Plate	201591-M15H01	1
4 position universal w/ 1/8" jack	107660-0114-00010	1
Overlay – AUX INPUT	201466-0007	1
Overlay – VOLUME UP	201466-0001	1
Overlay – VOLUME DOWN	201466-0002	1
Overlay – AUDIO SELECT	201466-0003	1
Overlay – SPKR ON OFF	201466-0278	1

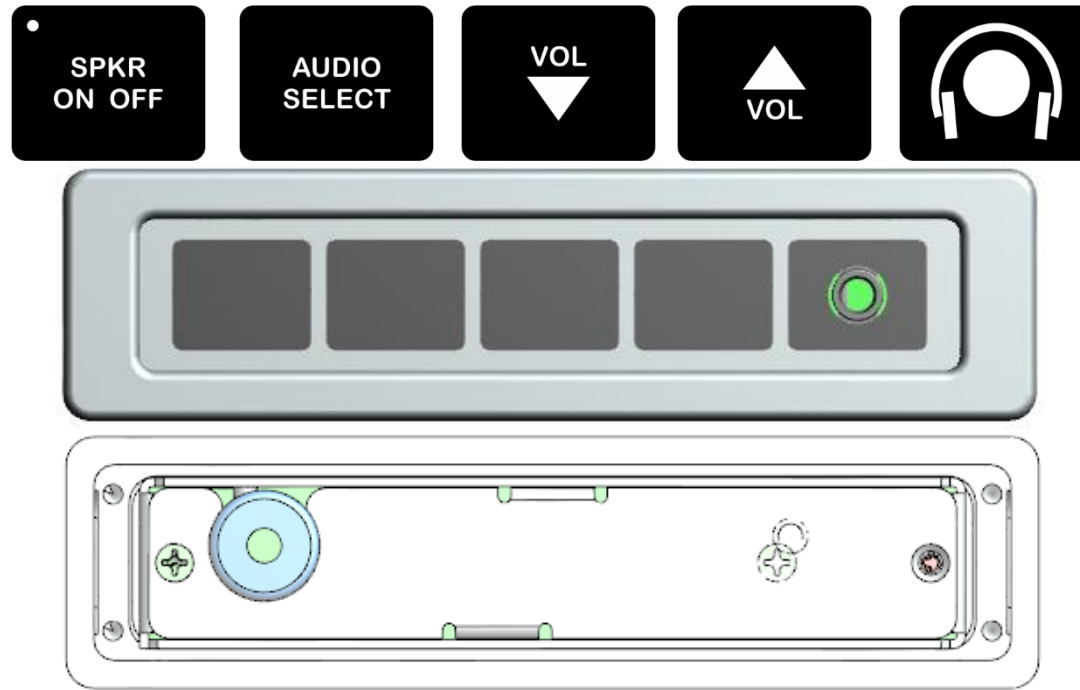

<b>Configuration #</b>	CSS-ALTO-D1505	<b>Plating Grain Direction</b>	↔
<b>Quantity</b>	1		
<b>BOM Rev #</b>	1		

Items in Configuration		
Description	PN	Quantity
Bezel	202582-D1501-R1	1
Trim Plate	201591-M15H01	1
4 position w/ 1/8" jack	107660-0104-00010	1
Overlay – HEADPHONE JACK	201466-0022	1
Overlay – VOLUME UP	201466-0001	1
Overlay – VOLUME DOWN	201466-0002	1
Overlay – AUDIO SELECT	201466-0003	1
Overlay – SPKR ON OFF	201466-0278	1

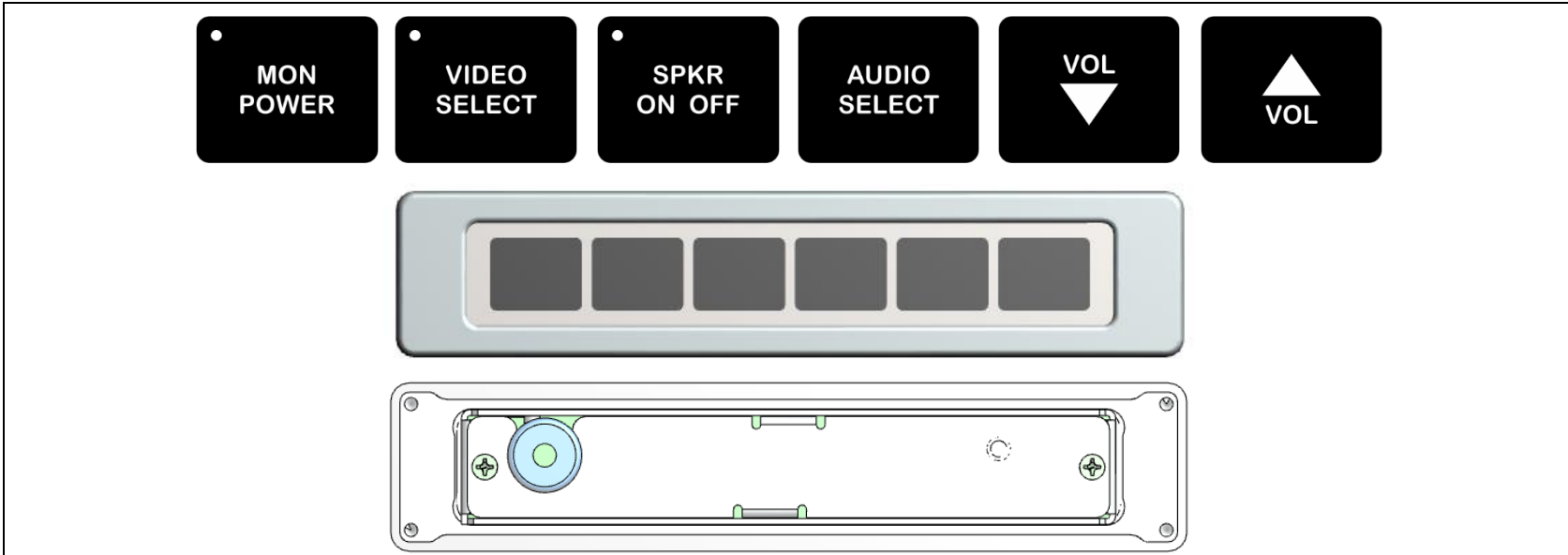

<b>Configuration #</b>	CSS-ALTO-D1601	<b>Plating Grain Direction</b>	<b>↔</b>
<b>Quantity</b>	1		
<b>BOM Rev #</b>	1		

Items in Configuration		
Description	PN	Quantity
Bezel	202582-D1601-R1	1
Trim Plate	201591-M16H01	1
6 position switch w/ indicator	107660-0006-00010	1
Overlay – VOLUME UP	201466-0001	1
Overlay – VOLUME DOWN	201466-0002	1
Overlay – AUDIO SELECT	201466-0003	1
Overlay – SPKR ON OFF	201466-0278	1
Overlay – VIDEO SELECT	201466-0020	1
Overlay – MON POWER	201466-0309	1

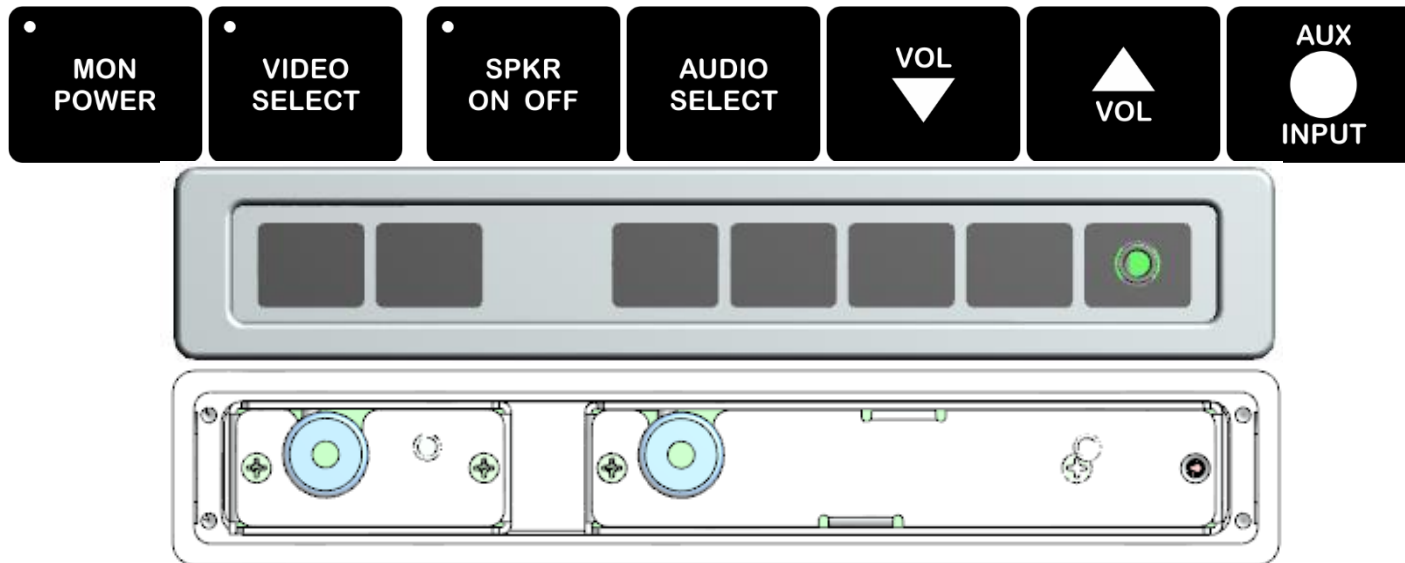

<b>Configuration #</b>	CSS-ALTO-D1801	<b>Plating Grain Direction</b>	<b>↔</b>
<b>Quantity</b>	1		
<b>BOM Rev #</b>	1		

Items in Configuration		
Description	PN	Quantity
Bezel	202582-D1801-R1	1
Trim Plate	201591-M18H13-R1	1
2 position switch w/ indicator	107660-0002-00010	1
4 position universal w/ 1/8" jack	107660-0114-00010	1
Overlay – AUX INPUT	201466-0007	1
Overlay – VOLUME UP	201466-0001	1
Overlay – VOLUME DOWN	201466-0002	1
Overlay – AUDIO SELECT	201466-0003	1
Overlay – SPKR ON OFF	201466-0278	1
Overlay – VIDEO SELECT	201466-0020	1
Overlay – MON POWER	201466-0309	1

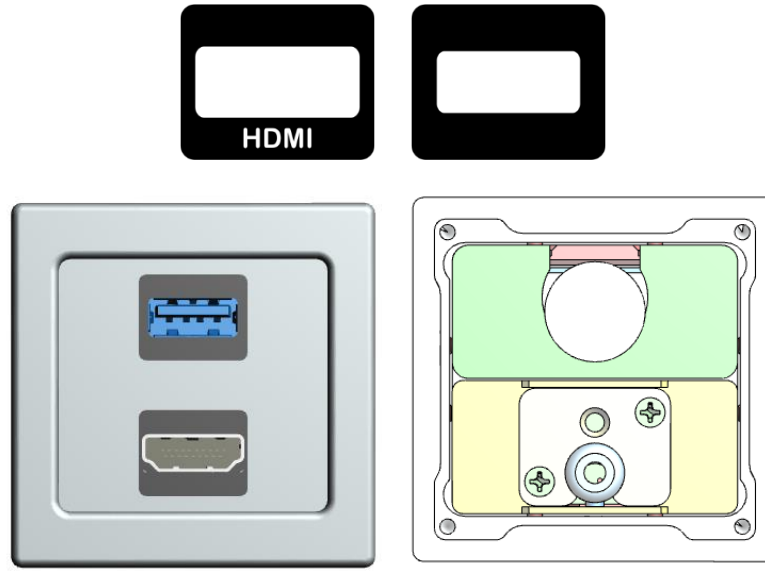

<b>Configuration #</b>	CSS-ALTO-D2201	<b>Plating Grain Direction</b>	↔
<b>Quantity</b>	1		
<b>BOM Rev #</b>	2		

Items in Configuration		
Description	PN	Quantity
Bezel	202582-D2201-R1	1
Trim Plate	201591-M22H03-R1	1
HDMI Extension Module	107665-2165-00010	1
USB Power Module 1x1	107665-2115-00010	1
Overlay – USB	201466-0029	1
Overlay – HDMI- TEXT	201466-0254	1

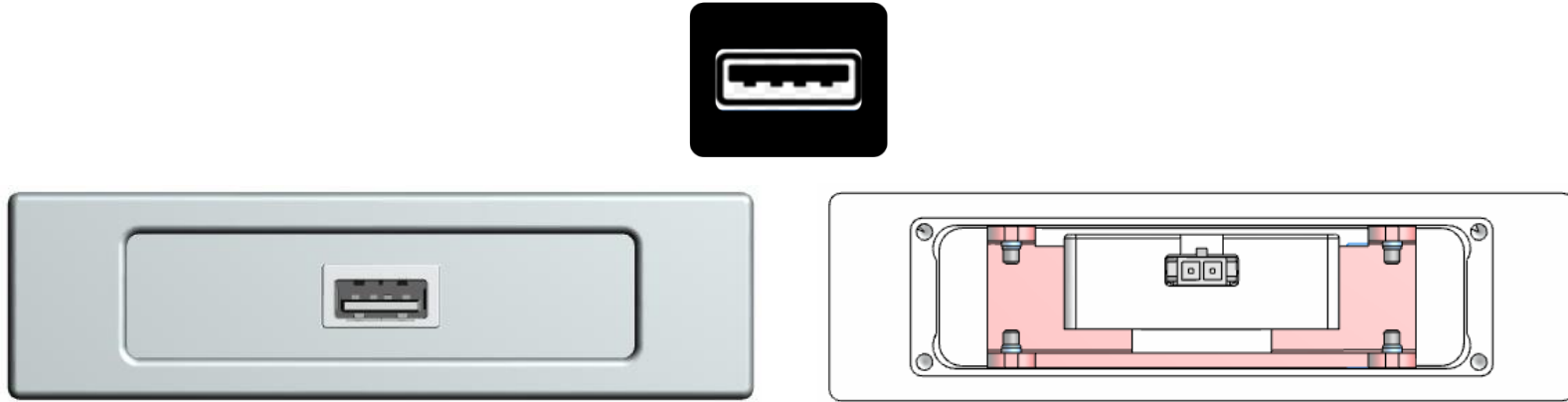

<b>Configuration #</b>	CSS-ALTO-K1401	<b>Plating Grain Direction</b>	<b>↔</b>
<b>Quantity</b>	1		
<b>BOM Rev #</b>	1		
Items in Configuration			
Description	PN	Quantity	
Bezel	202585-K1402	1	
Trim Plate	202591-K14H03	1	
USB Power Module 1x1	107665-0115-00010	1	
Overlay – BLUETOOTH ENABLE	201466-0271	1	
Overlay – AUDIO SELECT	201466-0003	1	
Overlay – USB	201466-0029	1	

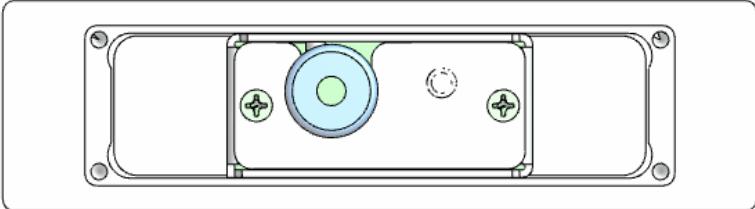

<b>Configuration #</b>	CSS-ALTO-K1402	<b>Plating Grain Direction</b>	<b>↔</b>
<b>Quantity</b>	1		
<b>BOM Rev #</b>	1		
Items in Configuration			
Description	PN	Quantity	
Bezel	202585-K1402	1	
Trim Plate	202591-K14H05-R1	1	
2 position switch w/ indicator	107660-0002-00010	1	
Overlay – BLUETOOTH ENABLE	201466-0271	1	
Overlay – AUDIO SELECT	201466-0003	1	

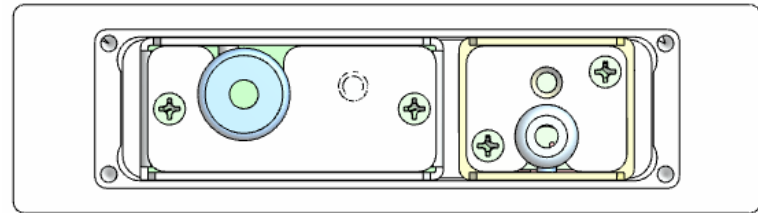

<b>Configuration #</b>	CSS-ALTO-K1403	<b>Plating Grain Direction</b>	<b>↔</b>
<b>Quantity</b>	1		
<b>BOM Rev #</b>	1		
Items in Configuration			
Description	PN	Quantity	
Bezel	202585-K1401	1	
Trim Plate	202591-K14H02	1	
USB Power Module 1x1	107665-0115-00010	1	
2 position switch w/ indicator	107660-0002-00010	1	
Overlay – BLUETOOTH ENABLE	201466-0271	1	
Overlay – AUDIO SELECT	201466-0003	1	
Overlay – USB	201466-0029	1	



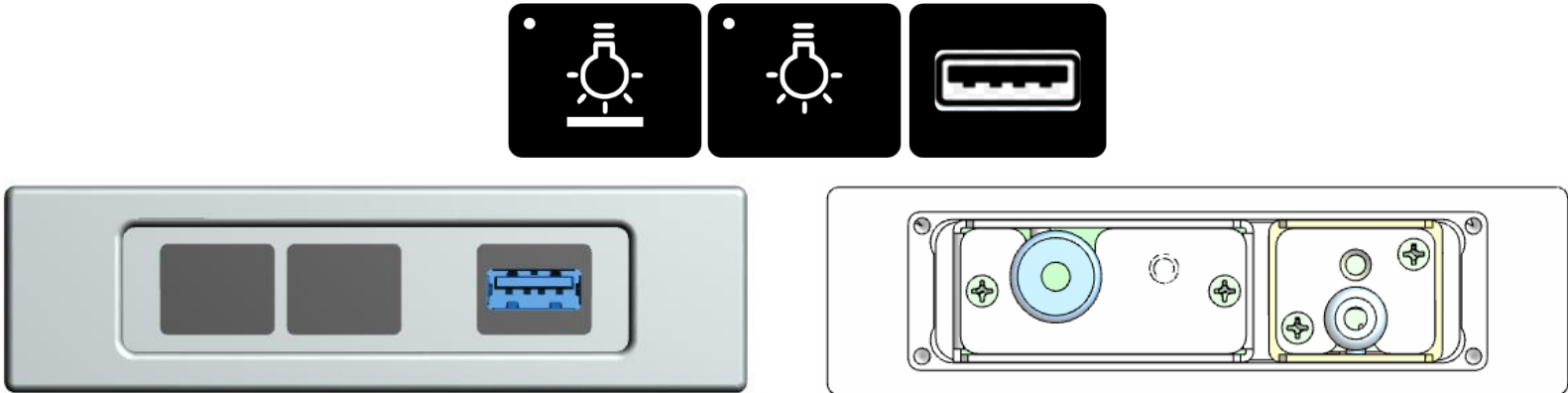

<b>Configuration #</b>	CSS-ALTO-K1404	<b>Plating Grain Direction</b>	<b>↔</b>
<b>Quantity</b>	1		
<b>BOM Rev #</b>	1		
Items in Configuration			
Description	PN	Quantity	
Bezel	202585-K1401	1	
Trim Plate	202591-K14H02	1	
USB Power Module 1x1	107665-0115-00010	1	
2 position switch w/ indicator	107660-0002-00010	1	
Overlay – TABLE LIGHT ICON	201466-0279	1	
Overlay – READ LIGHT ICON	201466-0283	1	
Overlay – USB	201466-0029	1	

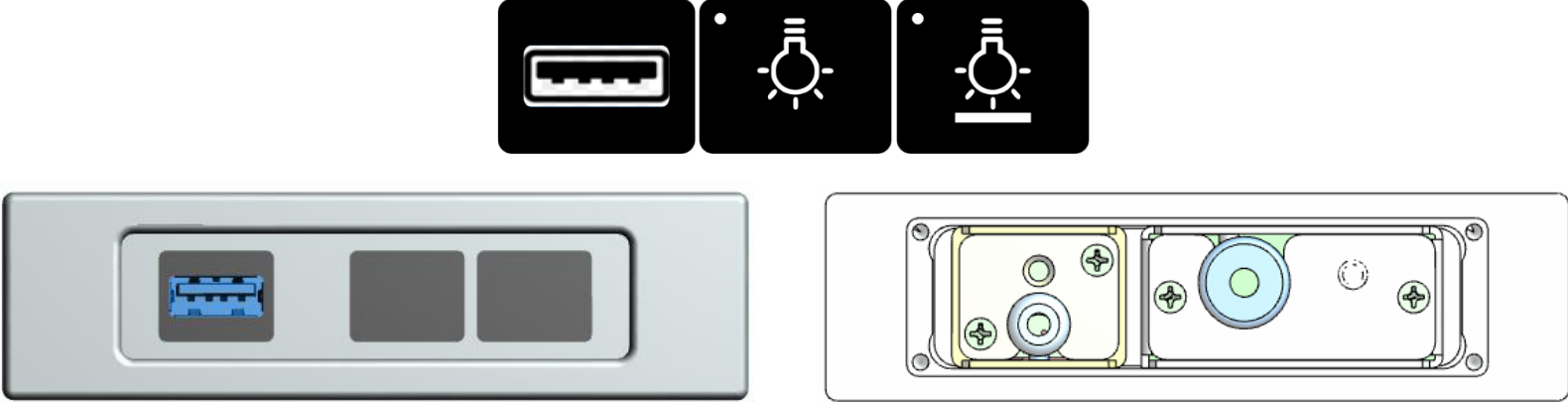

<b>Configuration #</b>	CSS-ALTO-K1405	<b>Plating Grain Direction</b>	
<b>Quantity</b>	1		
<b>BOM Rev #</b>	1		
Items in Configuration			
Description	PN	Quantity	
Bezel	202585-K1401	1	
Trim Plate	202591-K14H02	1	
USB Power Module 1x1	107665-0115-00010	1	
2 position switch w/ indicator	107660-0002-00010	1	
Overlay – TABLE LIGHT ICON	201466-0279	1	
Overlay – READ LIGHT ICON	201466-0283	1	
Overlay – USB	201466-0029	1	

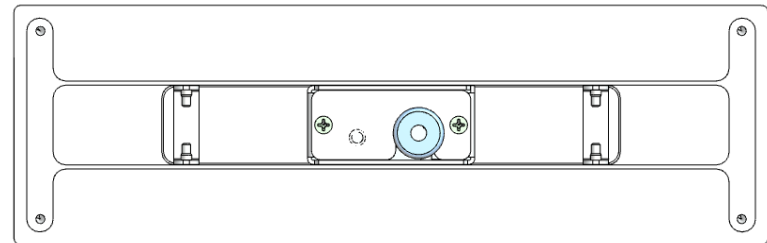
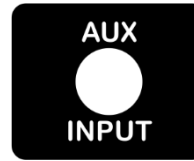

<b>Configuration #</b>	CSS-ALTO-T1601	<b>Plating Grain Direction</b>	
<b>Quantity</b>	1		
<b>BOM Rev #</b>	1		
Items in Configuration			
Description	PN	Quantity	
Bezel	202587-T1601-R1	1	
Trim Plate	201591-M16H08-R1	1	
1 position w/ 1/8" jack	107660-0101-00010	1	
Single Row Trim Plate Support Bracket	201403	2	
Overlay – BLUETOOTH ENABLE	201466-0271	1	
Overlay – AUX INPUT	201466-0007	1	

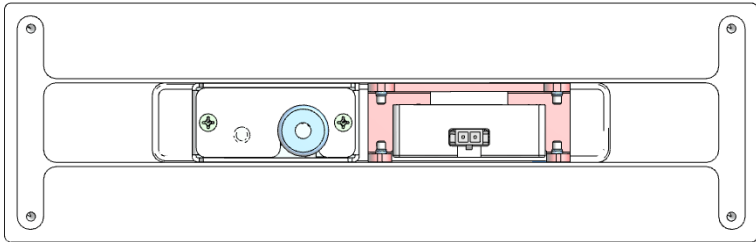
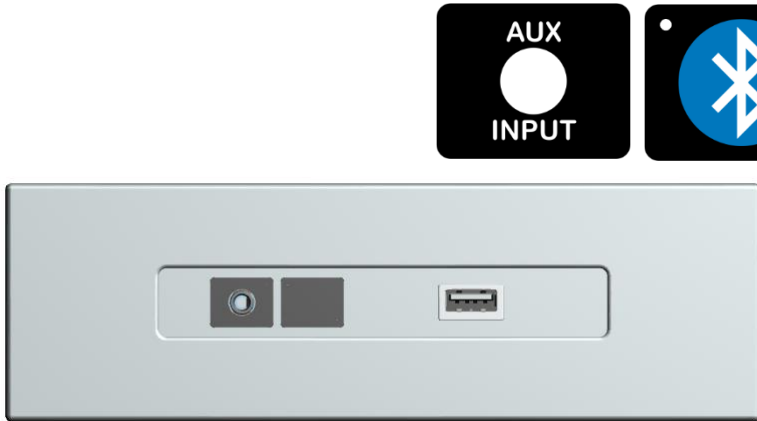

<b>Configuration #</b>	CSS-ALTO-T1602	<b>Plating Grain Direction</b>	
<b>Quantity</b>	1		
<b>BOM Rev #</b>	2		
Items in Configuration			
Description	PN	Quantity	
Bezel	202587-T1601-R1	1	
Trim Plate	201591-M16H11-R1	1	
USB Power Module 1x2.5 Horizontal	107665-0145-00010	1	
1 position w/ 1/8" jack	107660-0101-00010	1	
Overlay – BLUETOOTH ENABLE	201466-0271	1	
Overlay – AUX INPUT	201466-0007	1	

<b>ALTO Pre-Configured Series Dimensions</b>				
<b>Bezel</b>	<b>Top Height (in)</b>	<b>Top Width (in)</b>	<b>Bottom Height (in)</b>	<b>Bottom Width (in)</b>
202582-D1101-R1	1.133	1.614	0.883	1.364
202582-D1201-R1	1.133	2.307	0.883	2.057
202582-D1301-R1	1.133	3.000	0.883	2.750
202582-D1401-R1	1.133	3.693	0.883	3.443
202582-D1501-R1	1.133	4.386	0.883	4.136
202582-D1601-R1	1.133	5.079	0.883	4.829
202582-D1801-R1	1.133	6.465	0.883	6.215
202582-D2201-R1	2.104	2.100	1.850	1.854
202585-K1401	1.130	4.063	0.860	3.176
202585-K1402	1.130	4.063	0.860	3.176
202587-T1601-R1	2.340	7.420	2.090	7.170



<b>Size</b>	<b>Doc Type</b>	<b>Drawing Number</b>	<b>Rev #</b>	<b>Date</b>	<b>Page</b>
A	CD	CSS-ALTOCD	G	02/06/20	37 of 37